

1439 Malvern Road Glen Iris

Immaculately Presented Shop

Wilson Commercial is pleased to offer for lease 1441 Malvern Road, Glen Iris.

The Malvern Road retail precinct is home to a diverse mix of established retailers and high-performing hospitality operators, including The Malvern Hotel, Top Paddock and Teo's Pizza Bar, supporting a strong and consistent trading environment.

- Floor area: 63sqm approx.
- Polished floorboards and two consulting rooms with plumbing
- Accessible toilet
- Air-Conditioned
- Suitable for Retail, Medical or Beauty operators
- Direct access to the Route 72 tram and close proximity to Tooronga Train Station (approx. 400m*) and Gardiner Train Station (approx. 850m*)

\$40,000 +GST +Outgoings

Lan Nguyen
0421 410 466
nguyen@wilsonagents.com.au

Nicole Scrofani
0411 224 451
nscrofani@wilsonagents.com.au

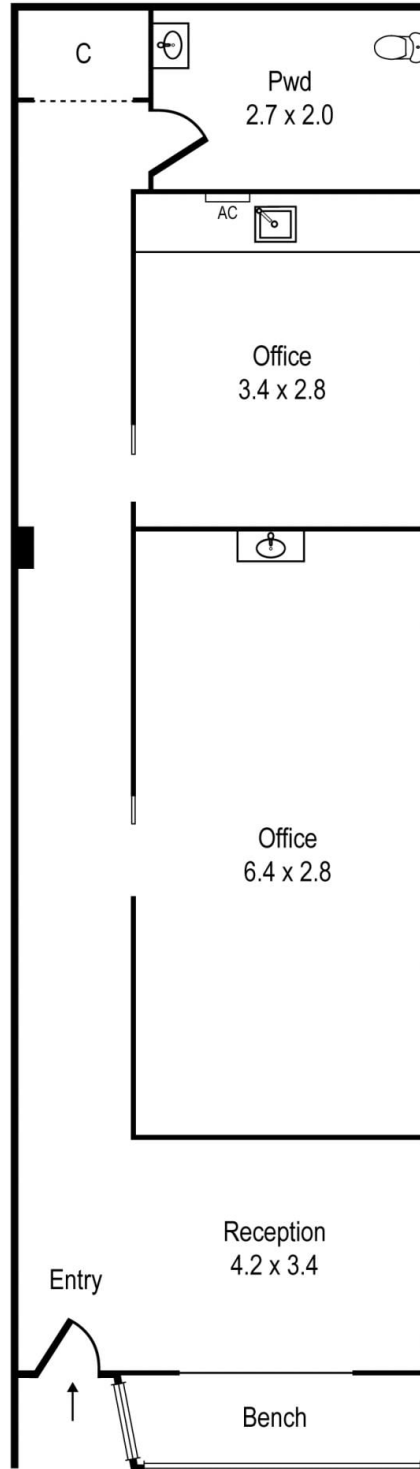

TOTAL SQM = 61.7sqm