



## 305/2 Chaucer Street ST KILDA

1 1 1

### Impeccable investment in unrivalled Luna Park locale

**\$500,000 - \$520,000**

Presenting an impressive investment proposition in a can't-miss location, this gleaming third-floor apartment sits proudly in the heart of St Kilda. Opposite Luna Park, overlooking O'Donnell Gardens, and just steps from St Kilda Beach, it sits in a highly desirable spot for tenants or guests.

Norma Evans  
0422844666  
nevans@wilsonagents.com.au

The residence is highlighted by a North-West-facing sunroom, where louvred windows beautifully blur the lines between outdoors and in. Overlooking O'Donnell Gardens and Luna Park's legendary scenic roller coaster, it offers an incredible view onto this vibrant stretch of St Kilda.

The WIR bedroom adjoins a bathroom with its walk-in shower and Euro laundry. The kitchen sparkles with stainless steel benchtops and Smeg appliances. And further features include a study/home office nook, split-system heating/cooling and secure garage carspace.

305/2 Chaucer Street, St Kilda

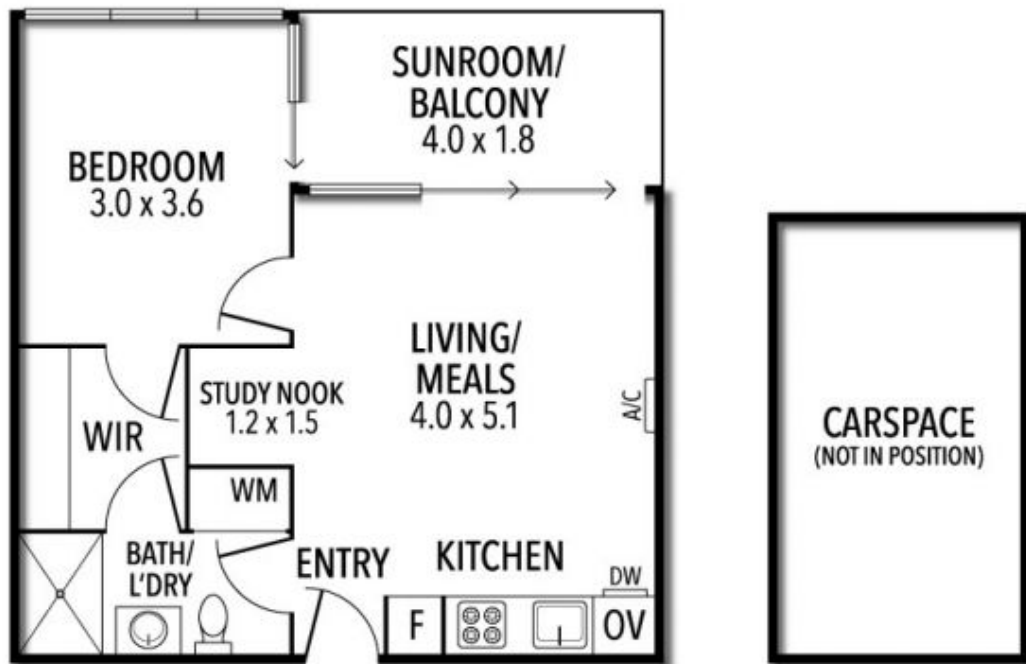

This plan has been prepared for marketing purposes only. Please note that all measurements & angles are approximate only, so it is strongly advised that all interested parties should undertake their own investigation into the accuracy of the supplied information. No representations or warranties of any nature whatsoever are given or attended.