



24A Kambea Grove CAULFIELD NORTH

3 2 2

Single level entertainer in the Golden Mile

Experience exemplary single level living in this stylishly updated 70's built residence nestled in the heart of the coveted Golden Mile. This exceptional home with a well planned flexible floorplan & zoned living is perfectly geared to young families looking to enter the neighbourhood or downsizers not wanting to compromise. A large lushly landscaped front garden greets you on arrival, while on the interior a wide & welcoming entrance hallway with timber floors creates a lasting first impression. Entertaining & family orientated living is easy with two impressively sized versatile living zones - an elegantly spacious carpeted formal lounge & dining room with custom built cabinetry & an expansive casual living & dining zone, both with lovely green aspect & sliding doors opening out to an elevated timber deck, alfresco area & blissfully tranquil rear garden surrounded by lush greenery, making indoor-outdoor relaxing & entertaining a breeze. Adding to the appeal is a well appointed granite kitchen with quality appliances (including integrated dishwasher & induction cooktop), a large walk in pantry & an abundance of storage & bench space. Away from the living zones a luxuriously appointed main bedroom with large walk in robe, built in robes & updated ensuite, two additional bedrooms (optional study) & a sparkling central

Joey Eckstein
0419419199
jeckstein@wilsonagents.com.au

Peter Fein
0418528888
peter@wilsonagents.com.au

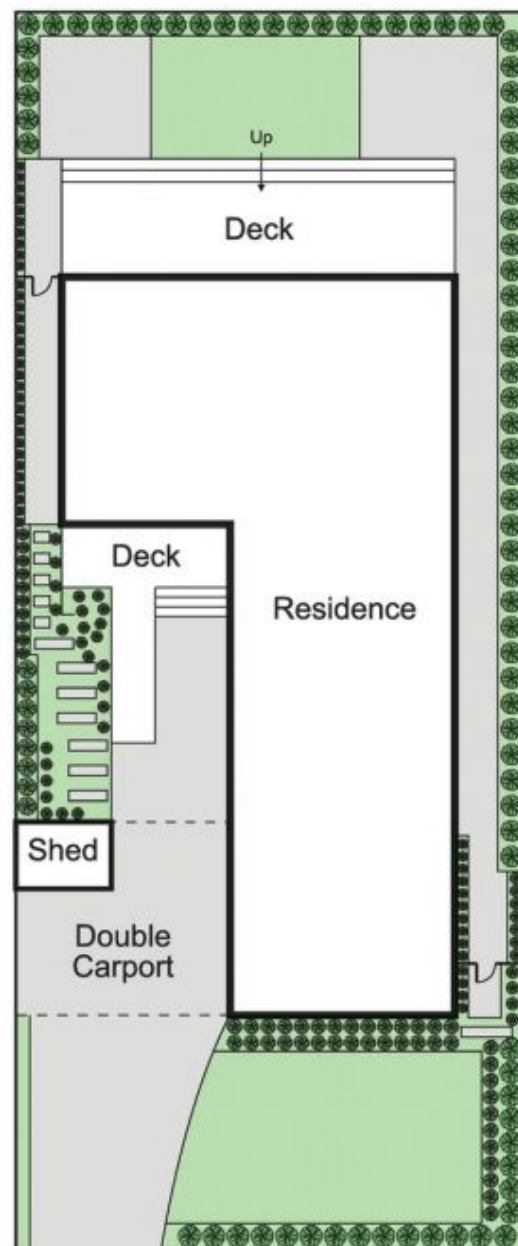
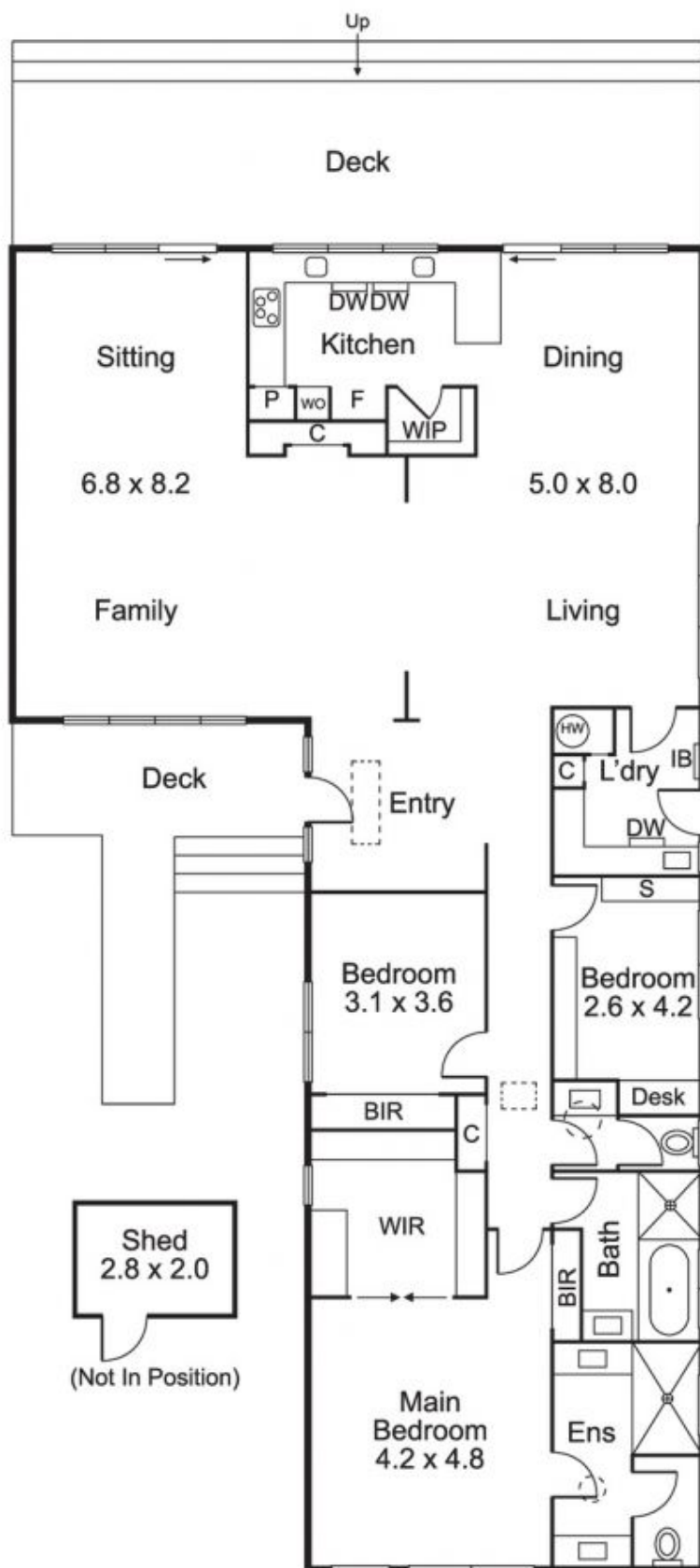

This plan has been prepared for marketing purposes only. Please note that all measurements & angles are approximate only, so it is strongly advised that all interested parties should undertake their own investigation into the accuracy of the supplied information. No representations or warranties of any nature whatsoever are given or attended.