



7/4A Wando Grove ST KILDA EAST

2 1 1

Built big in the 1960's

With generous proportions and leafy outlooks in this irresistible 1960's Strata apartment is one of the sweetest deals available in St Kilda East.

Peaceful and private on the 1st floor it comprises entry hall, generous lounge with adjoining balcony, modern kitchen with dishwasher and meals area, both bedrooms are king sized, intercom security and under cover parking.

Added further appeal is the close proximity to Alma Village shopping Centre, Dandenong Rd tramstop and Orrong Road bus transport.

Important information:

Year of construction - 1965

Property size - 70sqm approx plus balcony

Units in development - 21

Council rates - \$286 per 3 months

Owner Corp fees - \$729 per 3 months

Priced for immediate sale - \$520,000

Peter Fein

0418528888

peter@wilsonagents.com.au

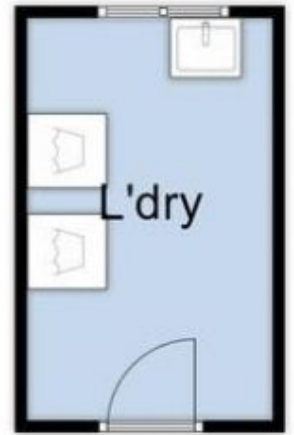
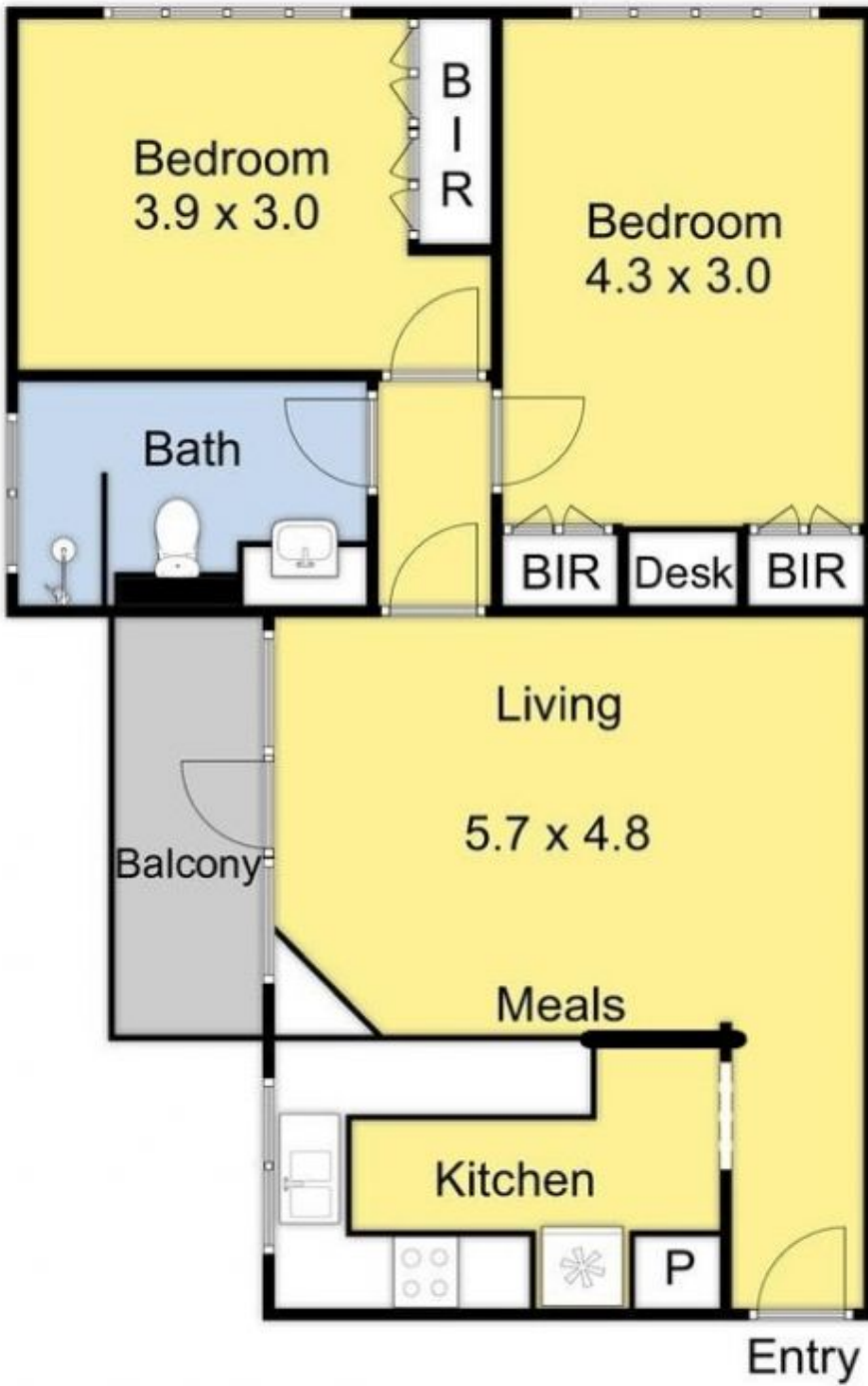

(Not on Title)



(Not in position)