



## 32/4 Wando Grove ST KILDA EAST

1 1 1

### Quiet treetop apartment offers investment potential

**\$ 220,000**

Delivering low-maintenance living, convenience and impressive lifestyle benefits, this one-bedroom St Kilda East apartment beckons investors with perennial tenancy appeal and untapped potential for renovation and enhancement. Set in an easily accessible spot just off the Princes Highway, it offers a great opportunity to enter into this vibrant real estate market.

Norma Evans  
0422844666  
[nevans@wilsonagents.com.au](mailto:nevans@wilsonagents.com.au)

Sitting on a corner top-floor spot amongst serene treetops, the apartment opens onto a central living space set on parquet-styled floors, where there's a sleek kitchen with oven and electric cooktop.

The bedroom finds mirrored built-in robes, the bathroom is home to a shower and laundry area, and further features include wall-panel heater and an undercover off-street parking space on title.

The great location sits tucked away in a quiet residential nook that's close to trams and the

32/4 Wando Grove, St Kilda East

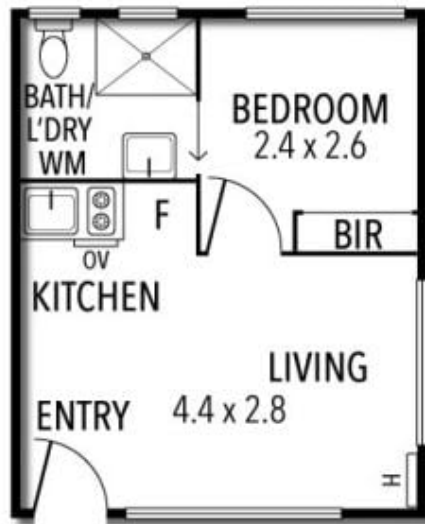

This plan has been prepared for marketing purposes only. Please note that all measurements & angles are approximate only, so it is strongly advised that all interested parties should undertake their own investigation into the accuracy of the supplied information.  
No representations or warranties of any nature whatsoever are given or attended.