

## Level 1, Suites 2&3/30 Inkerman St ST KILDA



### Well Appointed & Affordable St Kilda Office

**\$32,000 + GST + Outgoings**

Wilson Commercial are pleased to present for lease Level 1, Suites 2 & 3, 30 Inkerman St, St Kilda

Nicole Scrofani  
0411 224 451  
nscrofani@wilsonagents.com.au

Well-presented spacious office suite with a flexible floor plan. Nearby Acland Street offers supermarkets, cafés & restaurants

- Total Floor Area: 89 sqm (approx.) \*

Suite 2: 54.8 sqm approx.

Suite 3: 34.6 sqm approx.

- Common bathroom and kitchenette facilities

- Includes 1x Secure undercover car space

- Storage area

- Air conditioning/heating

- Available early August

Lan Nguyen  
0421 410 466  
languyen@wilsonagents.com.au

\* A partition wall can be removed to combine Suite 2 and 3 to make it one space.

# Level 1, Suite 2 & 3/30 Inkerman St, St Kilda

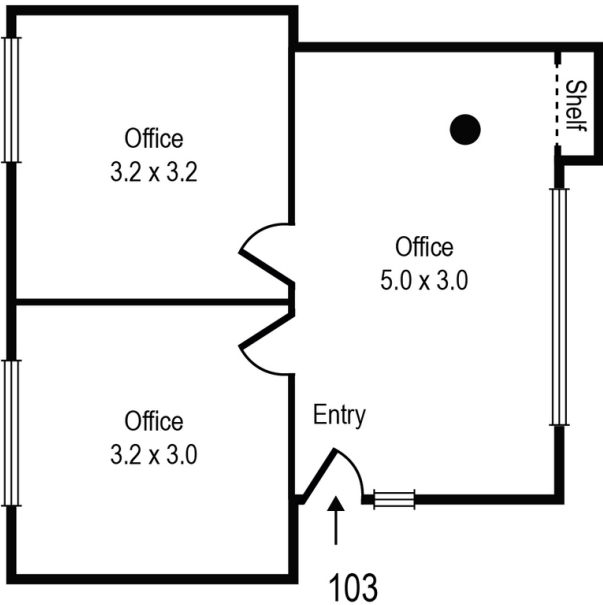
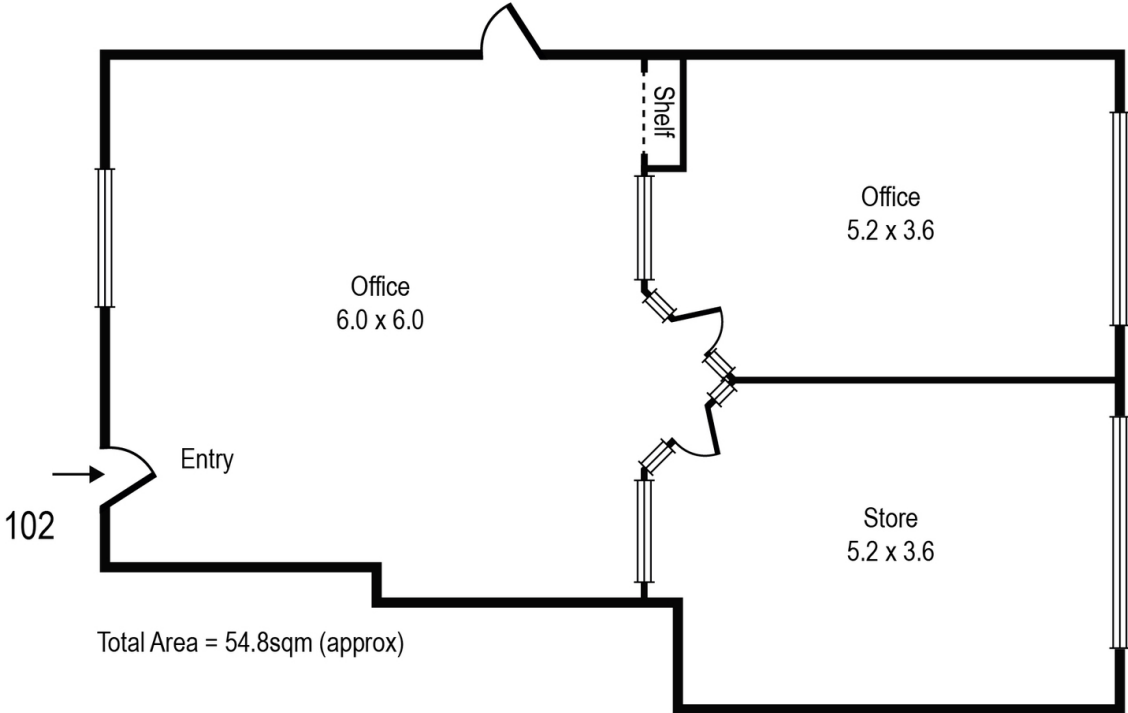

Whilst every attempt has been made to ensure the accuracy of this floorplan, measurements of doors, windows, rooms and any other items are approximates only. The producer or agent cannot be held responsible for any errors, omissions or misstatements. This plan is for illustrative purposes only and should be used as such.