

**20 Ercildoune Street Caulfield North**

**3** **2** **2**

## UNDER APPLICATION

Family sized with large rooms is what makes this modern residence stand out from the pack. You'll be impressed by the standard of renovations that this home has undergone. Comprises:

- 3 large bedrooms, all king size with robes
- Ensuite to 2 bedrooms,
- Massive open living and dining space with feature gas fireplace and a north / west aspect allowing for loads of natural light
- Sliding doors opens out to a sun drenched north west facing timber deck with low maintenance rear garden perfect for indoor-outdoor living
- well-equipped stone kitchen with large central island bench / breakfast bar, brand new stainless steel appliances with gas cooktop & an abundance of storage.
- Other features include separate laundry, ducted heating /air conditioning, alarm, video intercom entry, front and back underground watering systems, off street parking for two cars (one at the front accessed via a sliding front gate & the other accessed at the rear via ROW).

Peter Fein  
0418528888  
[peter@wilsonagents.com.au](mailto:peter@wilsonagents.com.au)



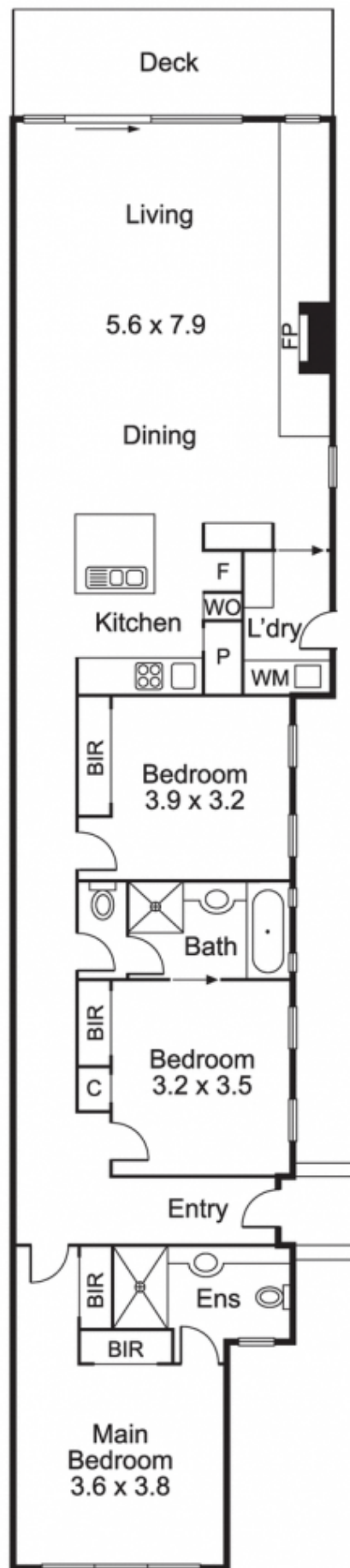

Disclaimer: The measurements and/or dimensions of both the land and property as well as any internal measurements and/or dimensions of any rooms are approximate and may not be accurate. Prospective purchasers should carry out their own measurements and enquiries and engage the services of a licensed surveyor. To the maximum extent permitted by law, Gary Peer & Associates Pty Ltd gives no guarantee or warranty whatsoever as to the accuracy or otherwise of the measurements and dimensions set out (including but not limited to errors or omissions) and expressly disclaims all liability for any loss or damage, whatever the cause, which may arise from any person acting and/or relying on such measurements and dimensions.