



54 Ashworth Street ALBERT PARK

3 **2** **2**

Contemporary Sophistication with a Stunning Roof Top TerraceA

Overflowing with an exquisite sense of style matched with contemporary luxuries, this stunning town residence is spread across three spectacular light-filled levels. Culminating in an amazing rooftop terrace with breath-taking views of the bay and CBD creating a relaxed chill-out zone or ultimate party spot under the stars, the executive-style home exemplifies the essence of contemporary sophistication.

An elegant entry foyer welcomes you inside before flowing past an ensuite bedroom to a large living room crafted for optimal comfort with a built-in desk for remote office work, bespoke wall unit, and sliding doors linking to a fabulous indoor/outdoor room for year-round enjoyment.

Enriched with an expansive sense of space thanks to high ceilings and full-height windows, the vast open-plan living/dining zone on the first floor is seamlessly connected with honey-toned floorboards, warmed by an ambient gas-log fireplace, and anchored by a gourmet kitchen adding panache and practicality with stone benchtops, full array of Smeg appliances for aspiring chefs, and an extra-long breakfast bar/island bench encouraging

Graeme Wilson
0418315645
gwilson@wilsonagents.com.au

Michael Morris
0411168381
mmorris@wilsonagents.com.au

54 Ashworth Street, Albert Park

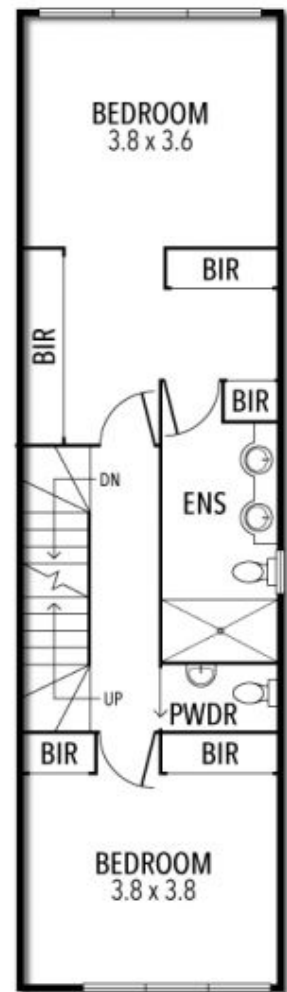
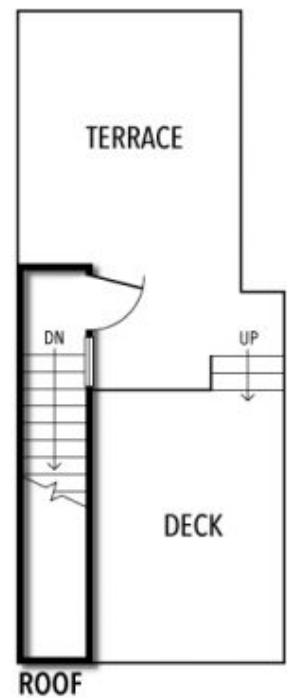
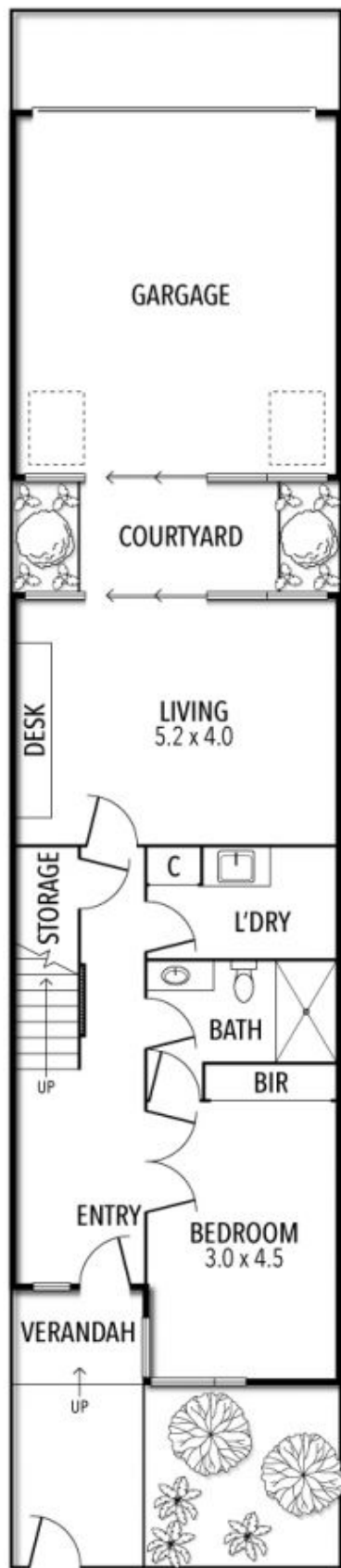

This plan has been prepared for marketing purposes only. Please note that all measurements & angles are approximate only, so it is strongly advised that all interested parties should undertake their own investigation into the accuracy of the supplied information. No representations or warranties of any nature whatsoever are given or attended.