



28/50 Hotham Street ST KILDA EAST

1 1 1

Built big in the 60s™s

Seriously advantaged by its position right at the rear of ROCKLEA GARDENS, this peaceful and generously proportioned one bedder excels in size and superb green views from all windows.

Located on the 1st floor the inviting entry leads to open plan living / dining, retro style kitchen with loads of cupboards and main large bedroom with walk in robes.

Added bonuses include split system air conditioning, carport and use of shared gardens just a few steps away. With public transport at your doorstep and the coffee capital that is Carlisle Street nearby you'll certainly enjoy the lifestyle.

Peter Fein
0418 528 888
peter@wilsonagents.com.au

28/50 Hotham Street, St Kilda East

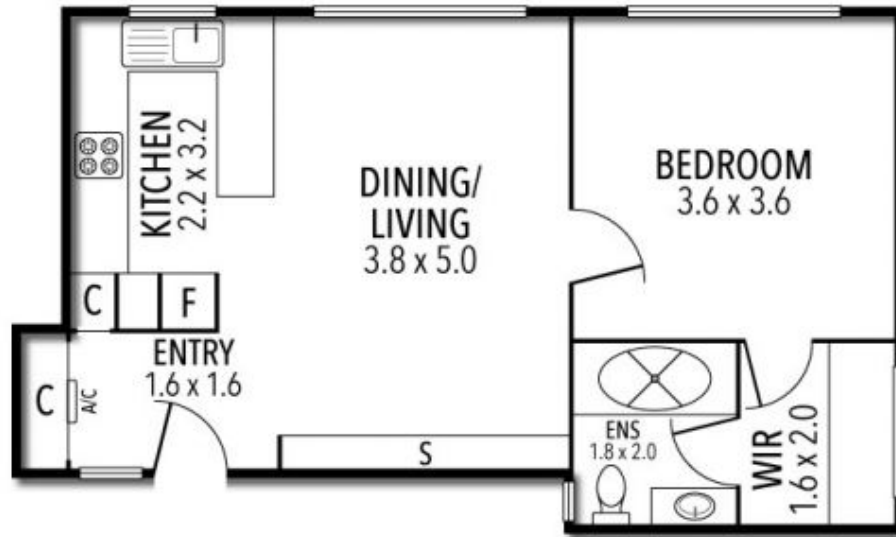

This plan has been prepared for marketing purposes only. Please note that all measurements & angles are approximate only, so it is strongly advised that all interested parties should undertake their own investigation into the accuracy of the supplied information. No representations or warranties of any nature whatsoever are given or attended.