

67 Church Street BRIGHTON

Classic on Church Street

Wilson Commercial are pleased to offer this excellent double story property located in one of Melbourne's most highly sought after locations in the heart of Church Street Brighton. Surrounded by quality brand name tenancies including Seed, Sheridan, Country Road, Carla Zampatti and eateries such as Mylk Café, The Deli and many more.

Key features:

- Total Area - 90 sqm approx.
- Ground floor - 50 sqm approx.
- First floor - 40sqm approx.
- Air-con systems
- Toilet/washroom located on first floor
- Open plan first floor area

Available Mid July 2021.

\$ 82,500

Alan Watson
0434 398 818
awatson@wilsonagents.com.au

Nicole Scrofani
0411 224 451
nscrofani@wilsonagents.com.au

67 Church St, Brighton



Ground Floor - 50sqm (approx)

First Floor - 40sqm (approx)

TOTAL - 90sqm (approx)

N

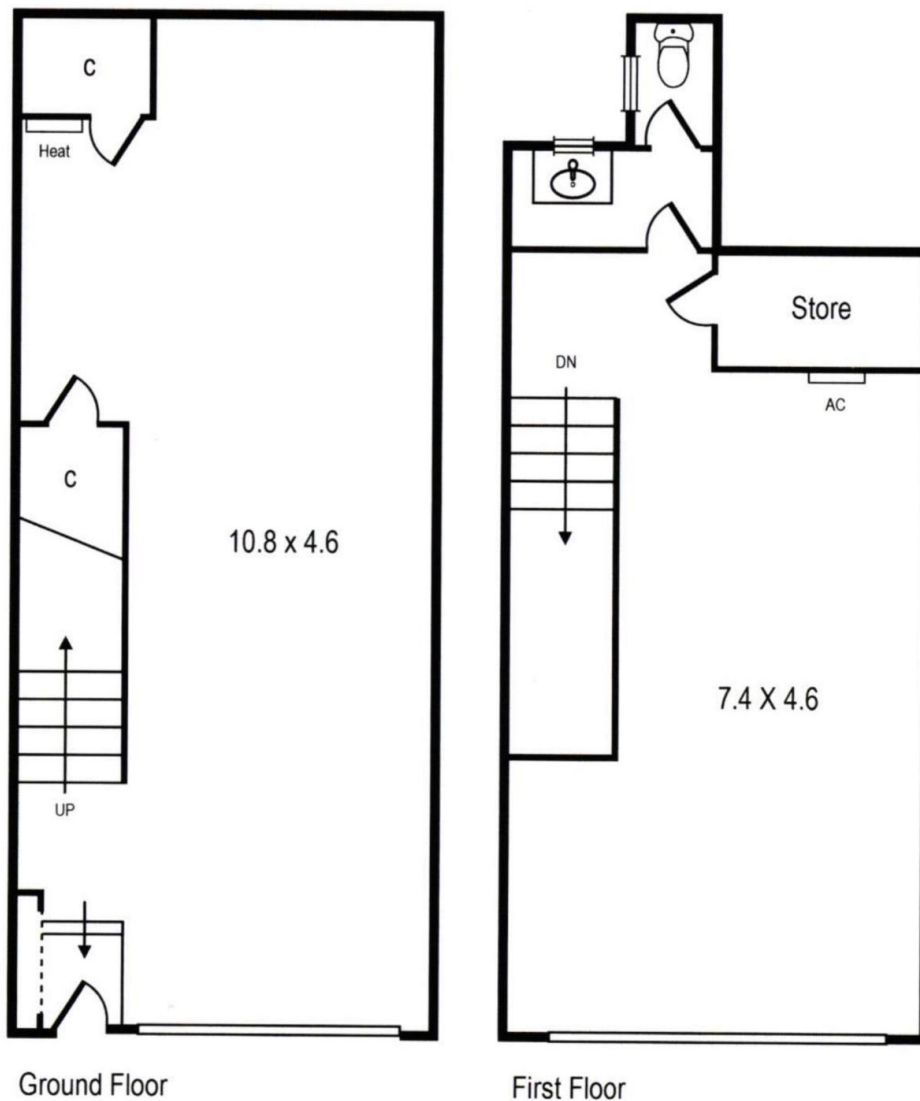

Ground Floor

First Floor

Whilst every attempt has been made to ensure the accuracy of this floorplan, measurements of doors, windows, rooms and any other items are approximates only. The producer or agent cannot be held responsible for any errors, omissions or misstatements. This plan is for illustrative purposes only and should be used as such.