



## 6A Linton Street ST KILDA EAST

2 1 2

### UNDER CONTRACT

**\$ 1,046,500**

You'll love the cutting edge design and superb views in this entertainers town residence located in a cul-de-sac just metres from cosmopolitan Carlisle St featuring some of Melbourne's best cafes and public transport.

The accommodation provided includes:

Downstairs: Security entrance leading to 2 or 3 bedrooms with main offering ensuite and built in robes, 2nd bedroom with robes and central bathroom.

Upstairs: Open plan supersized living and dining zones, kitchen with granite bench tops and stainless steel appliances leading out to the large elevated entertainers' party deck offering great views and absolute privacy.

Added bonuses include 2 car remote controlled garage, heating and air conditioning, alarm system and one of the most convenient addresses in St Kilda East.

Travis Fein  
0411873732  
tfein@wilsonagents.com.au

Peter Fein  
0418528888  
peter@wilsonagents.com.au

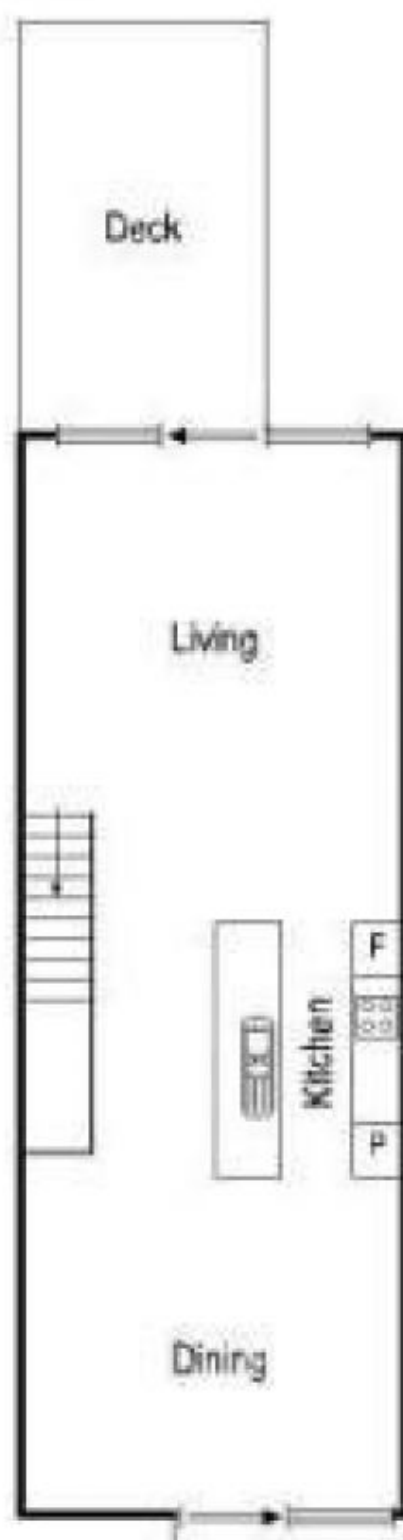

First Floor



Ground Floor

Please note this is a representation only and whilst every precaution is taken to ensure we provide you with accurate information regarding this property, Pricer strongly recommends you obtain your own measurements and/or engage the services of a qualified surveyor should you require exact dimensions. Pricer expressly denies responsibility for any omissions/errors contained herein.