

1306/8 Dorcas Street SOUTHBANK

2 **2** **1**

On Offer | Inner City Pad

Positioned in the sought-after Southbank location this superb 2 bedroom apartment is a step above the rest.

Upon entry you are greeted with a fully equipt kitchen fitted with Blanco stainless steel appliances which leads to the open plan living and dining with copious amounts of natural light due to its East facing orientation with views of the luscious greenery that surround the Shrine of Remembrance. Also benefitting from 2 large bedrooms, master with ensuite and central bathroom, a secure basement car park which makes this stunning apartment an enviable opportunity, whether you are looking for a secure investment or an inner-city pad this is the one for you.

Access to the best restaurants and cafès that Melbourne has to offer, public transport surrounding the block and close proximity to Albert Park Lake and the South Melbourne market.

Jayden Gleeson
0415061366
jayden@wilsonagents.com.au

Damon Kadlecik
0402251450
dkadlecik@wilsonagents.com.au

1306/8 Dorcas Street, Southbank

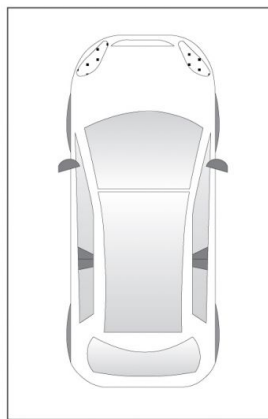
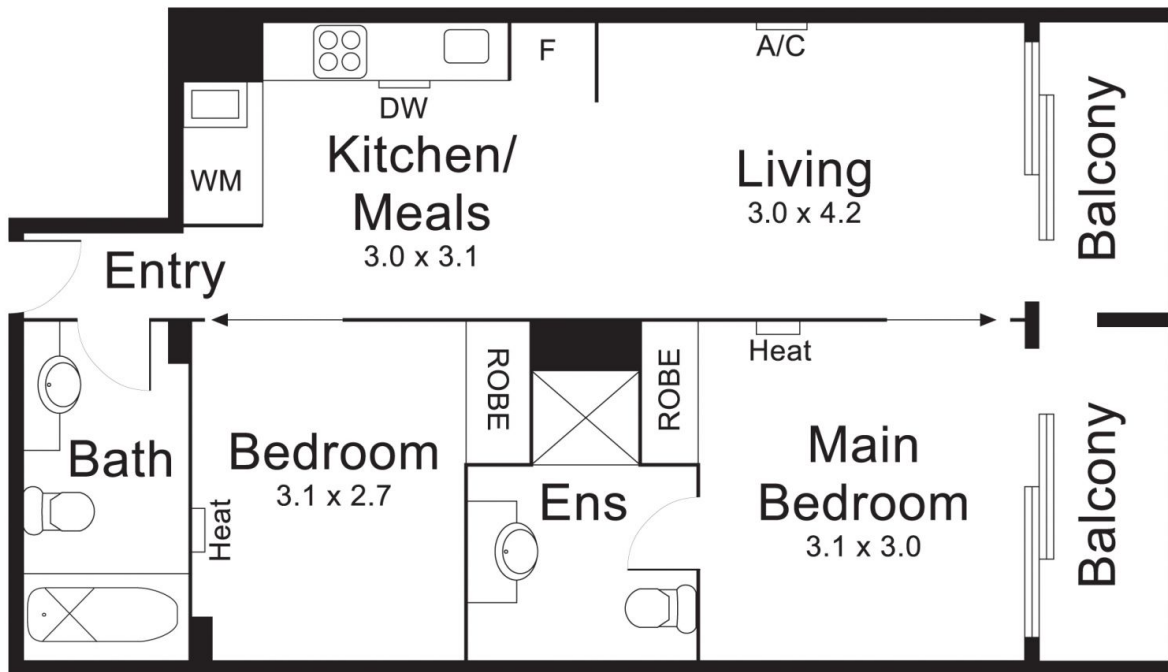

(not in position)

Internal : 58 m² approx.

External : 10 m² approx.

This plan has been prepared for marketing purposes only. Please note that all measurements & angles are approximate only, so it is strongly advised that all interested parties should undertake their own investigation into the accuracy of the supplied information.
No representations or warranties of any nature whatsoever are given or attended.