



1/2 Alfriston Street ELWOOD

2 **1** **1**

UNDER OFFER - Elwoodâ€™s Most Affordable 2 Bedder in a Classic 70â€™s Block

Enjoy the Elwood lifestyle in this awesome Strata apartment set in a popular sought after location. Refurbished only a few years ago, this 1st level front and secure home features:

- Two double bedrooms both with built in robes
- Large open plan living / dining room
- Separate kitchen with superb fitout and dishwasher
- Excellent bathroom network with separate bath, shower and wc
- Laundry facilities
- Enhanced with pleasant views
- Secure undercover car park via remote gates.

Superbly located only a short stroll to both Ripponlea Village, Carlisle Street and public transport.

Body corporate - \$500 per 3 months (\$2,000 per year)

Council rates - \$1,033.00 per year

Peter Fein
0418 528 888
peter@wilsonagents.com.au

Travis Fein
0411873732
tfein@wilsonagents.com.au

1 / 2 Alfriston Street, Elwood

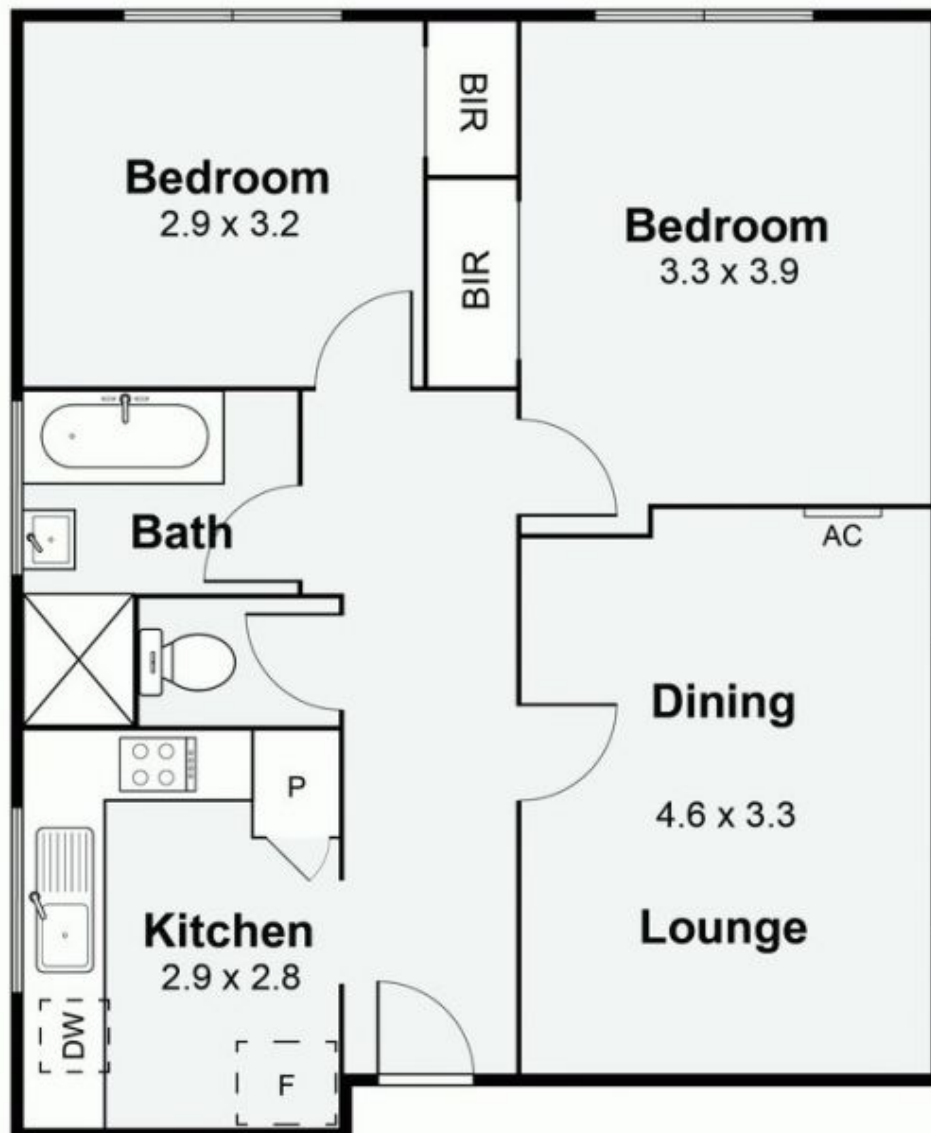

Car Space

(not in position)