



This property is available
for private inspection
7 days a week.

Contact Peter Fein on
0418 528 888
to arrange an inspection.



3/20 Carlisle Avenue ST KILDA EAST

2 **1** **1**

All you need is good taste

\$ 502,500

THIS PROPERTY IS AVAILABLE TO VIEW 7 DAYS A WEEK. PHONE OR TEXT PETER FEIN ON 0418 528 888 TO ARRANGE A TIME.

Travis Fein
0411873732
tfein@wilsonagents.com.au

A superb 2 bedroom well planned strata apartment in this beautifully maintained block of only 6.

Peter Fein
0418528888
peter@wilsonagents.com.au

Perfectly positioned in one of Balaclava's premier tree lined Avenues it has all the benefits of cosmopolitan Carlisle Street just a short stroll away.

The ground floor unit offers generous living, separate kitchen, two large bedrooms and car parking.

Just bring your creative mind and add your personal touch - then enjoy the many happy returns this superb home or investment offers.

3/20 Carlisle Avenue, St Kilda East

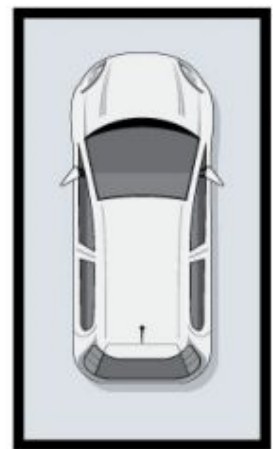
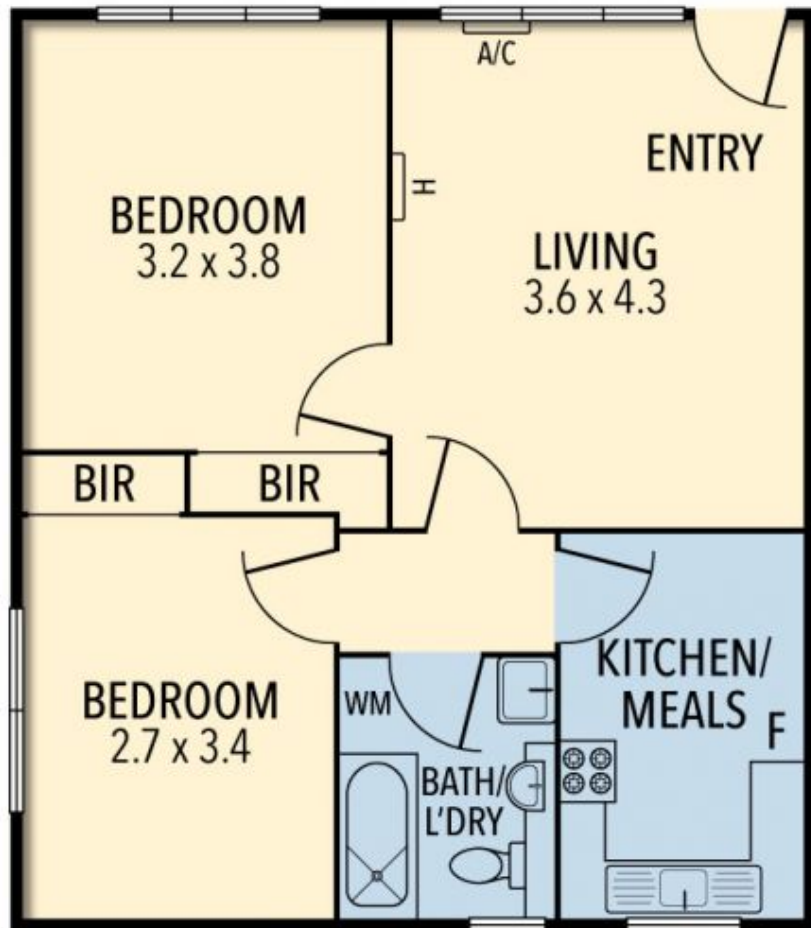

CARSPACE
(NOT IN POSITION)



This plan has been prepared for marketing purposes only. Please note that all measurements & angles are approximate only, so it is strongly advised that all interested parties should undertake their own investigation into the accuracy of the supplied information.
No representations or warranties of any nature whatsoever are given or attended.