



6/219 Williams Road SOUTH YARRA

1 1

Smartly Updated, Superbly Located

An enviable entry-level opportunity or welcome addition to any property investment portfolio, this ground-floor apartment is located for the ultimate in convenience.

Solidly built and quietly set towards the rear of the block, the one-bedder showcases an open-plan living room and kitchen with the asset of an open study area. The ensuite bathroom is fitted with a shower-over-the-bath and the apartment has a reverse-cycle air conditioner, storage cupboards in the living room and bedroom and secure intercom entry are further inclusions.

Enjoy a lifestyle of total seclusion on the doorstep of buses and moments from Hawksburn Station, trams routes and the vibrant Village atmosphere in the Hawksburn shopping precinct with its sidewalk cafés, restaurants, bakeries, fruit and veg, boutiques and Woolworths. Chapel Street, Toorak Road and Rockley, Princes and Victoria Gardens are also nearby.

Norma Evans
0422844666
nevans@wilsonagents.com.au

Joey Eckstein
0419419199
jeckstein@wilsonagents.com.au

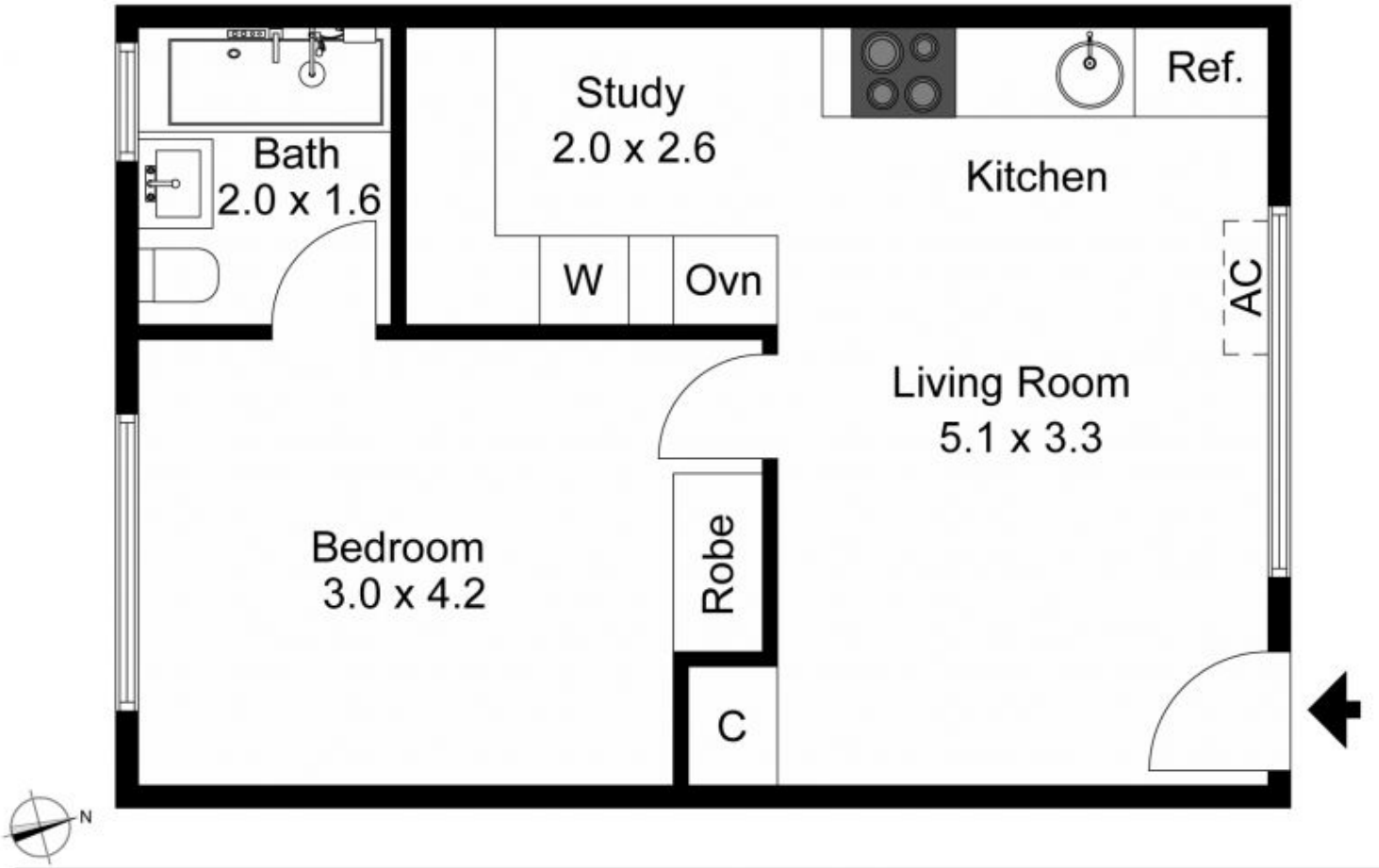

The floor plan is not to scale; measurements are indicative and in metres. Exterior elements are not in position. Plans should not be relied on. Interested parties should make and rely on their own enquiries.

Produced by DIAKRIT