



**38 Chapel Street ST KILDA**

**2** **1** **1**

## 1ST HOME MAGNET

**\$ 967,000**

This lovely Art-Deco home C1936 will just draw you into its captivating charm! Set on a 184sqm allotment in this appreciating location so close to all wanted amenities.

Graeme Wilson  
0418315645  
[gwilson@wilsonagents.com.au](mailto:gwilson@wilsonagents.com.au)

Retaining much of its original period charm, this gorgeous 2 bedroom, 1 bathroom semi has been freshly painted and features floorboards throughout, decorative ceilings and an open fireplace.

Featuring private garden entry to entrance hall, a spacious living area, king-sized master bedroom with wall to wall built-in robes and a huge picture window, second queen-sized bedroom with built-in robes, updated bathroom and eat in kitchen that overlooks a rear citrus garden escape.

Rich with period charm, modern appointments yet offering further scope for further improvement. This is a fantastic opportunity to join the action of cosmopolitan St Kilda.



## 38 Chapel Street, St Kilda

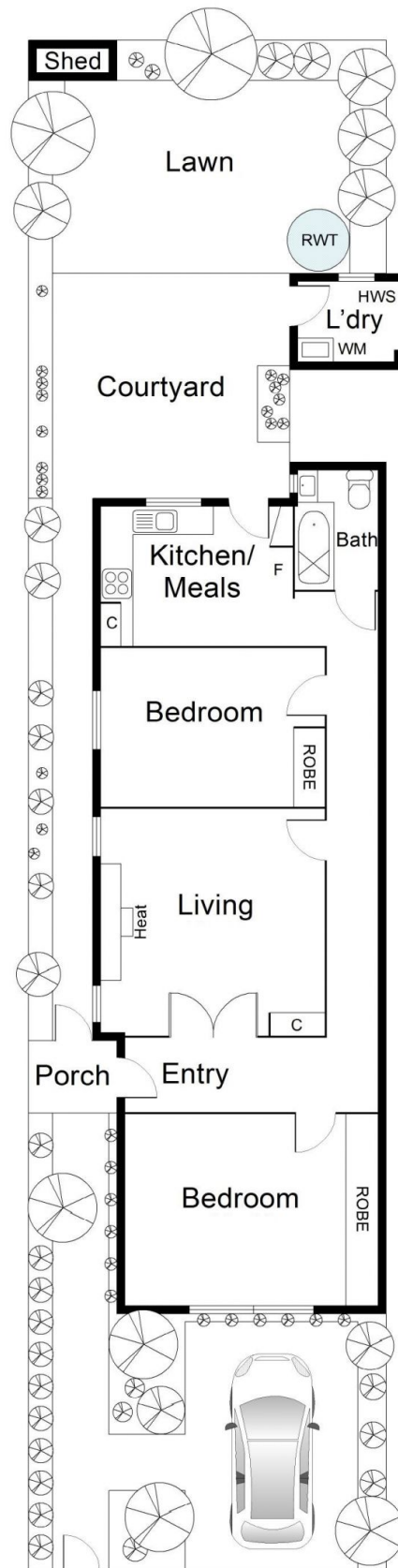

This plan has been prepared for marketing purposes only. Please note that all measurements & angles are approximate only, so it is strongly advised that all interested parties should undertake their own investigation into the accuracy of the supplied information. No representations or warranties of any nature whatsoever are given or attended.