



2A Liscard Street ELSTERNWICK

3 2 2

Move In and Enjoy OR Build Your Dream Home on This Corner Block (STCA)

This contemporary low maintenance home has been built with the entertainer in mind. The large open plan living area features a grand central fireplace and floor to ceiling windows opening on to a paved entertaining area and swimming pool.

This 3 bedroom, 2 bathroom home has plenty of room for a family and with a classic floorplan including a separate laundry and secure 2 car garage. The master bedroom has a large walk-in wardrobe and a funky ensuite bathroom. The kitchen has plenty of storage as do the remaining bedrooms.

The home has timeless cutting-edge finishes with exacting detail, defining the quality in the home. Abundant features include R/C air conditioning, intercom, pool, and 2 secure off street car spaces.

Outstanding position, a heartbeat to some of Melbourne's best schools, around the corner

Graeme Wilson
0418315645
gwilson@wilsonagents.com.au

Norma Evans
0422 844 666
nevans@wilsonagents.com.au

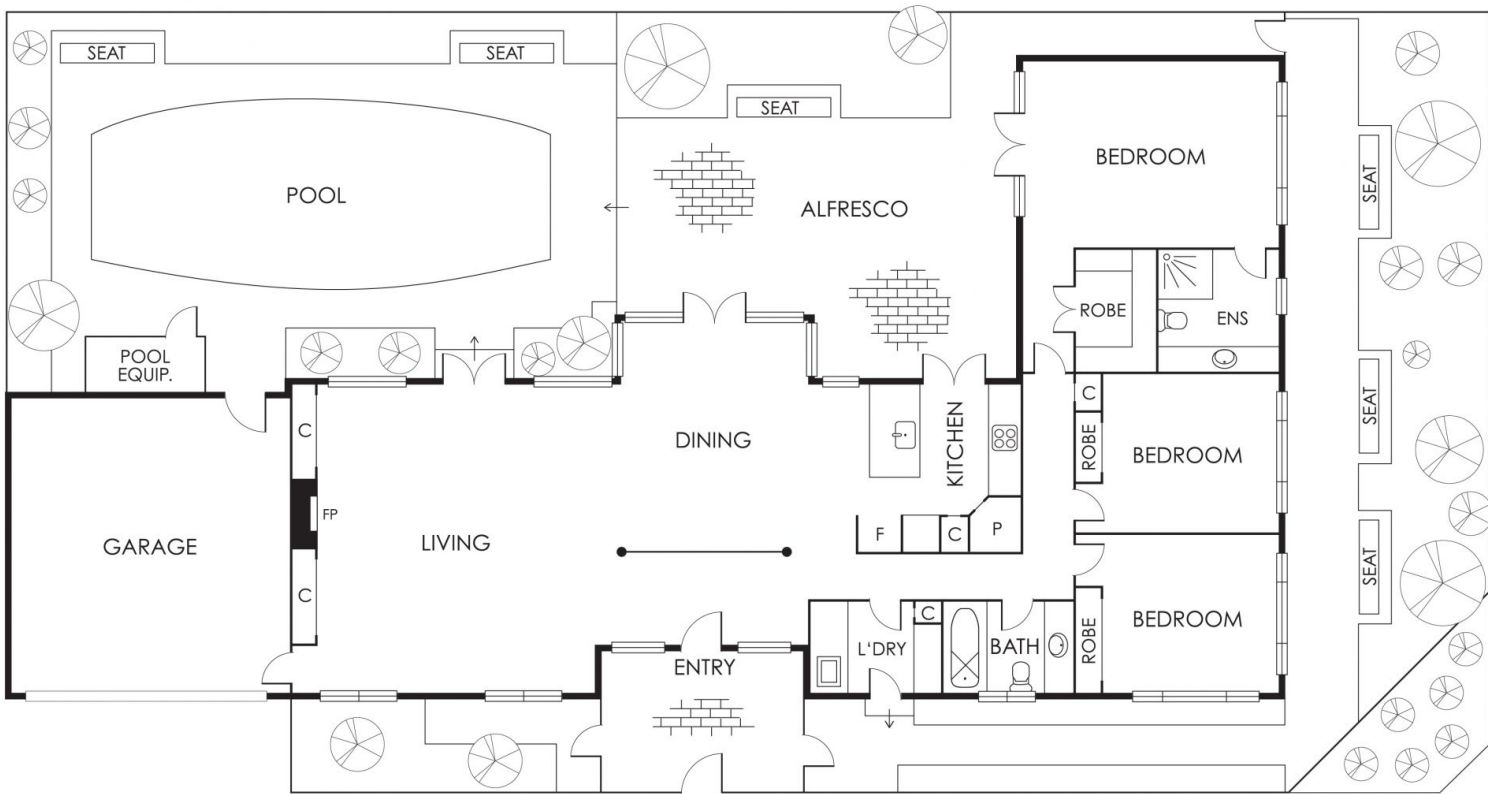

This plan has been prepared for marketing purposes only. Please note that all measurements & angles are approximate only, so it is strongly advised that all interested parties should undertake their own investigation into the accuracy of the supplied information. No representations or warranties of any nature whatsoever are given or intended.