

**17 Curral Road ELSTERNWICK**

4 2 2

## A Cubby House for the Kids, a Gorgeous Victorian Home for Mum & Dad

Perfectly positioned a short stroll from Harleston Park, this gracious freestanding Victorian family residence might be the "prettiest house?" on one of the neighbourhood's most beautiful streets.

Walk through the white picket fence, past the picture perfect front garden, and onto the raised veranda, and you will see you are in for something special. This stunning home blends classic Victorian architecture with stylish modern living.

Built on bluestone foundations, this 4 bedroom 2.5 bathroom home is grand in scale and offers an ideal floorplan on a prized allotment of 525m2 approx. Generous room sizes, soaring decorative ceilings, bay windows, marble open fire places and lace fretwork all create an air of refinement.

The architecturally-designed extension maximises entertaining space, with open plan kitchen, living and dining areas. Oversized double-glazed bi-fold doors and windows open to a north facing outdoor entertaining area, and allow natural light to filter throughout. The serenity of the mature rear garden is enhanced by a water feature, and there is an elevated

Grace Le-Francke  
0419379998  
glefrancke@wilsonagents.com.au

Graeme Wilson  
0418315645  
gwilson@wilsonagents.com.au

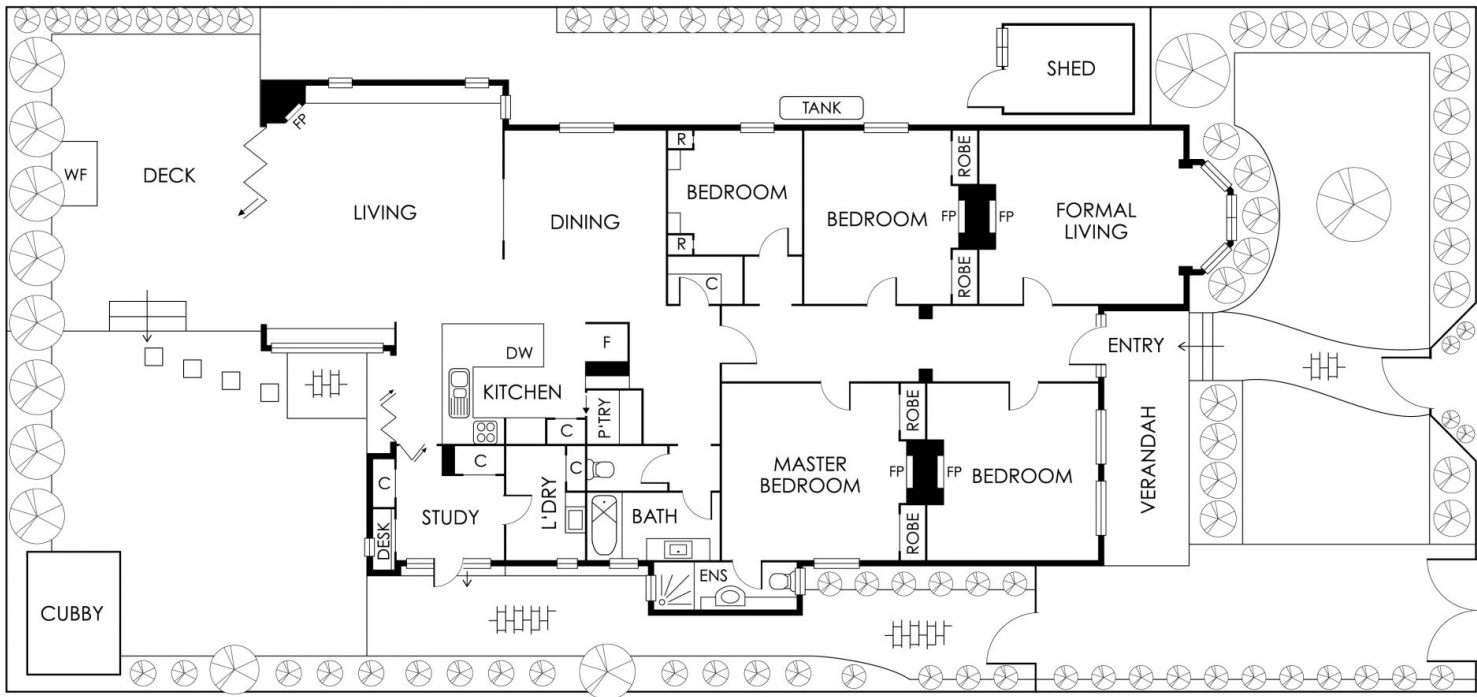

This plan has been prepared for marketing purposes only. Please note that all measurements & angles are approximate only, so it is strongly advised that all interested parties should undertake their own investigation into the accuracy of the supplied information. No representations or warranties of any nature whatsoever are given or intended.