



7/21 Park Street ST KILDA WEST

1 1 1

Supersized 60's awaiting your Good Taste

Choose one or choose both.

Elevated on the first-floor in a character 1960's block of only 8, this king-sized apartment is a solid choice for first home buyers or investors in a popular lifestyle location.

With both apartments in need of a makeover your efforts will be rewarded in this location just a stroll to the best that St Kilda has to offer with Fitzroy St, the Beach & transport all nearby.

\$ 462,000

Travis Fein
0411873732
tfein@wilsonagents.com.au

Norma Evans
0422844666
nevans@wilsonagents.com.au

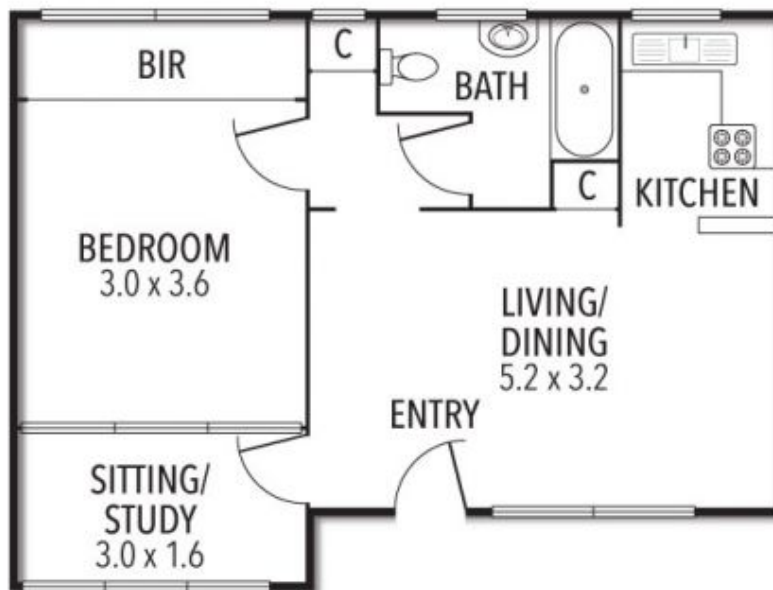

FLAT 7
46 SQM (APPROX.)



FLAT 8
47 SQM (APPROX.)

