



## 1st Floor/30 Inkerman Street ST KILDA

### WALK RIGHT IN! 1ST FLOOR OFFICE SUITES

1st Floor office suites include 1 secure on site car park (per suite). Suite 3 - 34 sq. m. approx. - \$9k pa plus outgoings & GST Short or long term leases available Shared kitchen & bathroom amenities. Also available, ground floor shop/showroom/office - 210 sq. m approx. \$69k pa plus outgoings & GST INSPECTION BY APPOINTMENT

Nicole Scrofani  
0411 224 451  
nscrofani@wilsonagents.com.au

# Suite 1&2, 30 Inkerman St, St Kilda



Suite 1 = 128sqm (approx)

Suite 2 = 68sqm (approx)

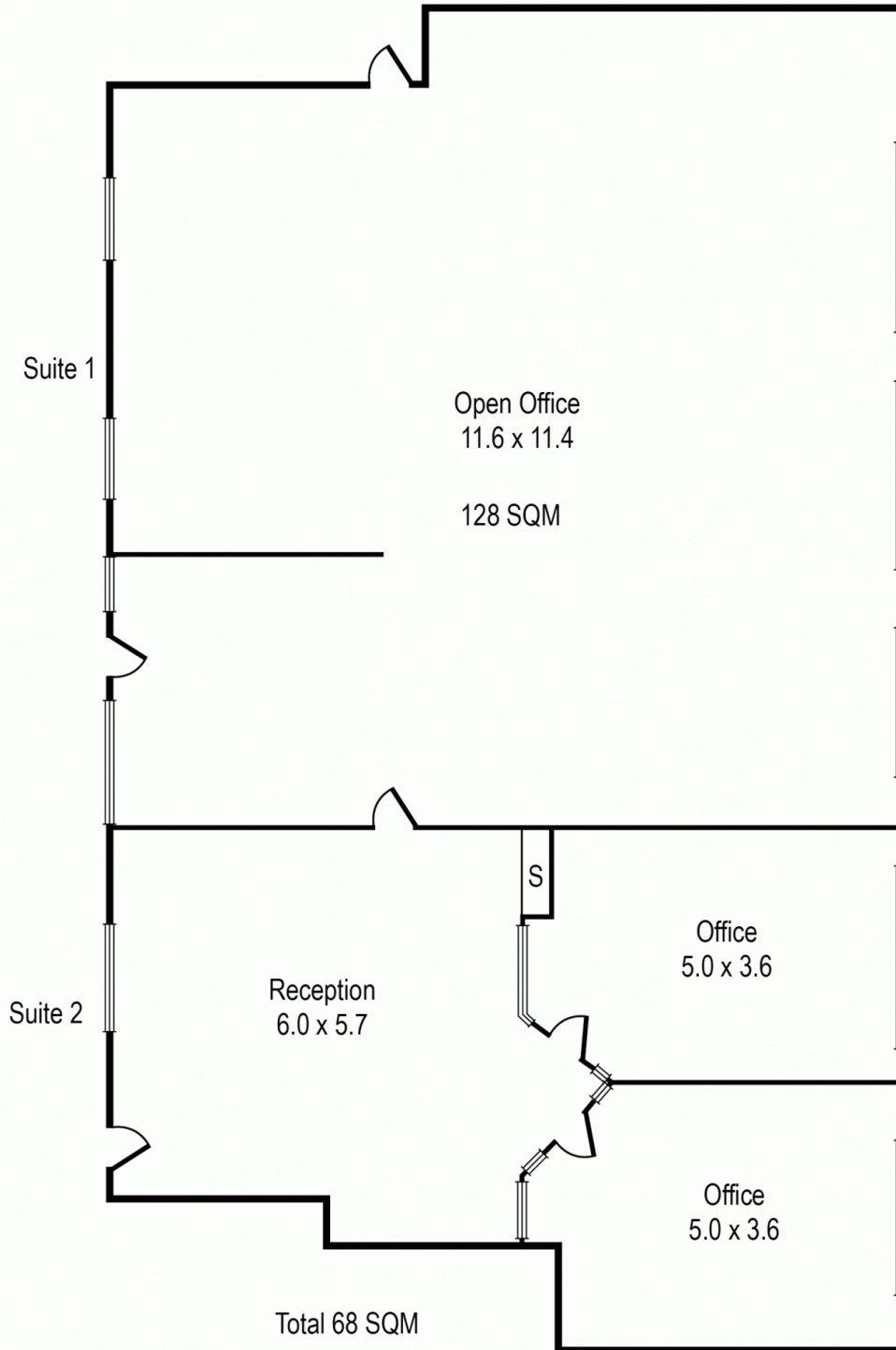

Whilst every attempt has been made to ensure the accuracy of this floorplan, measurements of doors, windows, rooms and any other items are approximates only. The producer or agent cannot be held responsible for any errors, omissions or misstatements. This plan is for illustrative purposes only and should be used as such.