

440 Glenhuntly Road ELSTERNWICK

*** UNDER OFFER ***

Brilliantly located opposite Coles and amongst many yummy eateries, this compact lock up shop of approx. 45 sq. m. (484 sq. ft.) also includes rear year/car parking for up to 2 vehicles. Versatile modern space will suit a variety of uses - retail, food, hair/beauty - you decide (STCA). Rental: \$35,000 p.a. plus outgoings (owner presently not registered for GST). AVAILABLE Mid May 2015

INSPECTION BY APPOINTMENT PH: 9528 8888

Nicole Scrofani
0411 224 451
nscrofani@wilsonagents.com.au

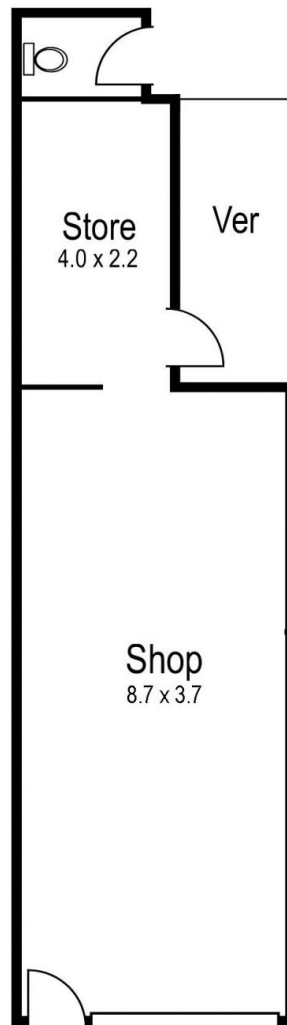

Total Area Approx 43.2 sqm

440 Glenhuntly Rd Elsternwick