



**42/449 St Kilda Road MELBOURNE**

**3** **1** **1**

**Kia Ora, Top floor, Top shelf**

**\$ 890,000**

Kia Ora. C 1933. A 3 bedroom top floor apartment so sought after, so delectably decadent. Art Deco building situated on Melbourne's most beautiful boulevard and backing onto Fawkner Park with your own key to access acres of parkland. This wonderful abode features light filled rooms with leafy outlook, polished hardwood floors, open fireplaces, deco plasterwork, newly renovated bathroom, European laundry and secure carpark. All the convenience of Chapel St, Albert Park Lake, St Kilda and CBD within walking distance, or just jump on the tram from outside your door.

Graeme Wilson  
0418315645  
gwilson@wilsonagents.com.au

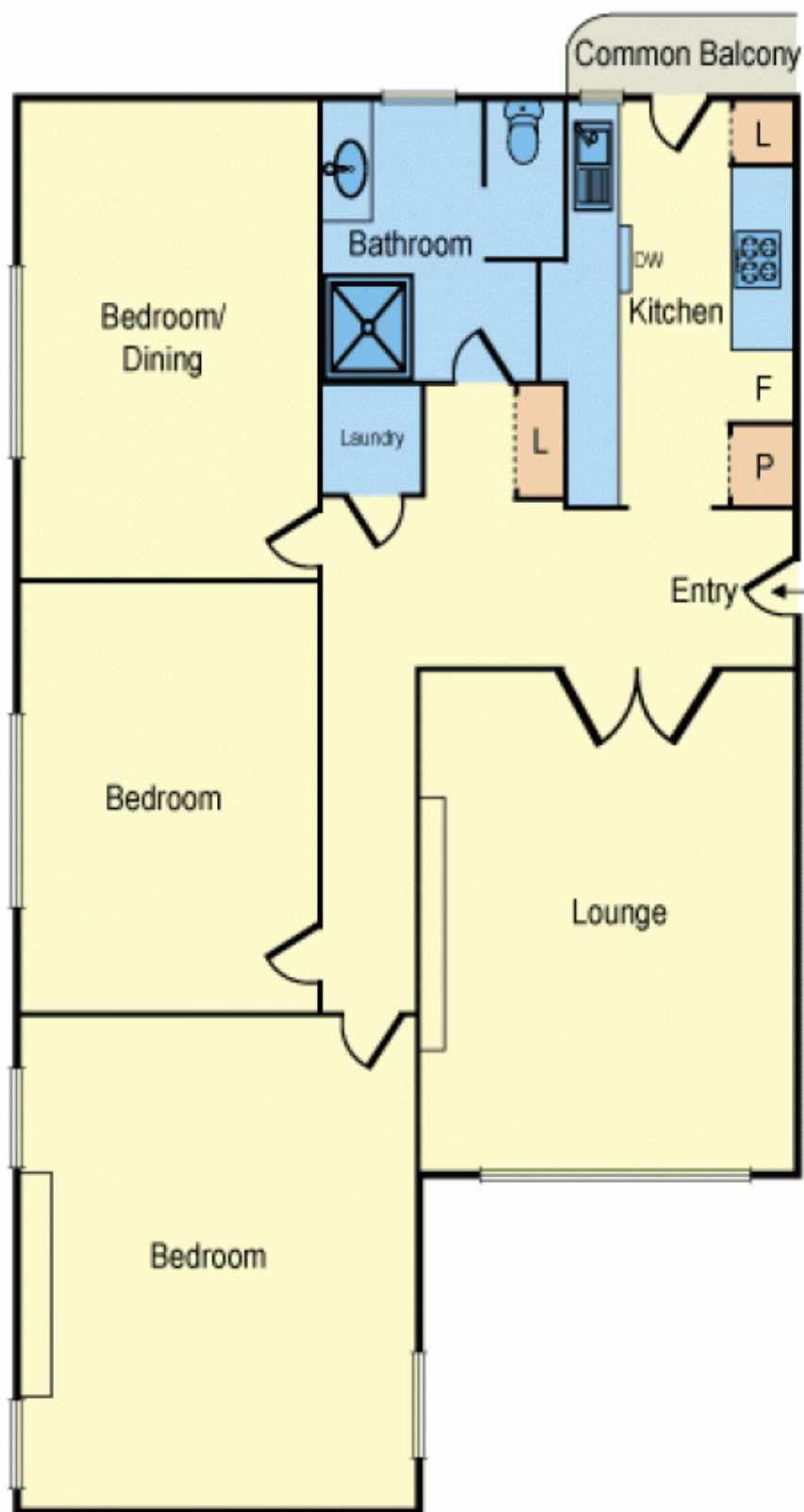

Carspace  
(Not In Position)